

Thank you for purchasing FAUCETWO+. Please read the instructions before using the controller.

Contents List

FAUCETWO+ Controller	1
Product Manual	1
USB A to C cable	1
USB A to B cable	1

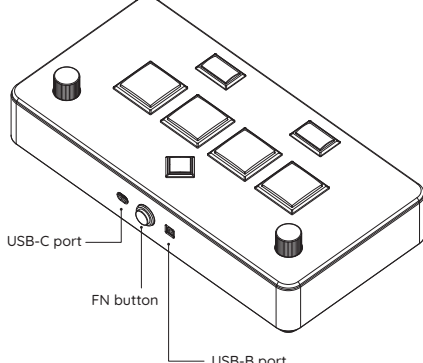

Connection

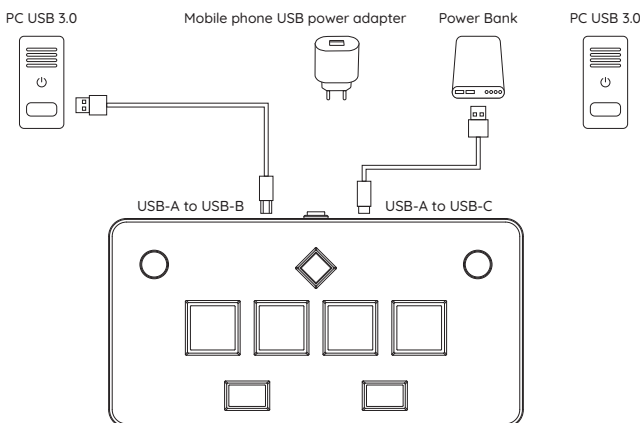

⚠ Caution !!!

- The use of **USB hubs** is not recommended. If necessary, ensure that it is a hub with an independent power supply.
- It is recommended to connect the **USB-A** end of a **USB-A to USB-B** cable directly to the **USB-A** port on the computer's motherboard. Connecting to the front **USB-A** ports of the computer case is discouraged due to potential connectivity and performance issues.
- For a **USB-A to USB-C** cable connection, it is advisable to use a port that provides **5V/1A** or higher current.
- If **RGB** lighting brightness is not a concern, it is permissible to leave the **USB-C** connector unconnected.

Modes and key values

The key combinations need to be pressed simultaneously and held for more than **3** seconds. When all button lights go out, it means the switch is successful.

START + FX-L + FX-R + BT-A

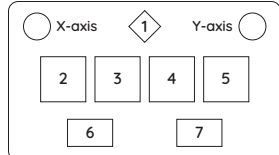

eAcloud mode (default)

SOUND VOLTEX (eAMUSEMENT Cloud)
you can run the game directly without setting the buttons.

KSM / USC / Spicetxxls
Key mapping is required.

START + FX-L + FX-R + BT-B

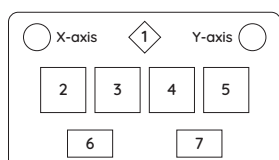

HID joystick mode

Setting lights is supported in **Spicetxxls**.

KSM / USC / Spicetxxls
Key mapping is required.

START + FX-L + FX-R + BT-C

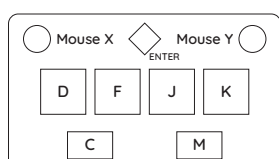

Keyboard & Mouse Mode

Setting lights is supported in **Spicetxxls**.

KSM / USC / Spicetxxls
Key mapping is required.

START + FX-L + FX-R + BT-D

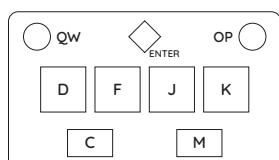

Keyboard mode

VOL-L outputs **Q** and **W**;
VOL-R outputs **O** and **P**.

Other key combinations

Function	Key combination
Show current mode	Start + FX-L + FX-R
Reduce knob dead zone	FN + FX-L
Increase knob dead zone	FN + FX-R
Adjust left LED light color	Start + BT-A + FX-L + VOL-L
Adjust VOL-L LED light color	Start + BT-B + FX-L + VOL-L
Adjust VOL-R LED light color	Start + BT-C + FX-R + VOL-R
Adjust right LED light color	Start + BT-D + FX-R + VOL-R
Adjust default Light-bar color	Start + BT-B + BT-C + VOL-L
Switch light-bar mode	Start + BT-B + BT-C + FX-L + FX-R
Turn off / turn on all lights	Start + BT-A + BT-B + BT-C + BT-D

Damping adjustment

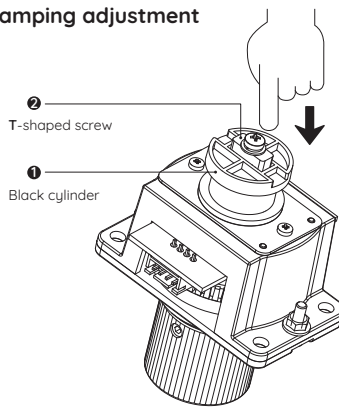

- ① Press the black cylinder ① to reveal the screws.
- ② Turn the T-shaped screw ② clockwise to increase damping; turn the T-shaped screw counterclockwise to reduce damping;
- ③ Put the T-shaped screw ② into the slot after adjustment.

⚠ Caution !!!

- When turning clockwise, stop turning as soon as the T-shaped screw nearly touches the black cylindrical object, as this is the limit. Do not tighten further. If it is not possible to insert the T-shaped screw into the slot, an Allen key can be used for assistance.
- When turning counterclockwise, ensure that the T-shaped screw does not unscrew completely and fall out.

Warranty period: 180 days from delivery date

GAMO2 warrant that we will comply with this aftermarket terms, and it doesn't cover the accessories of this product.

- Within 1-7 days, whatever problem happens, GAMO2 will provide free maintenance, free replacement, and bear the shipping cost.
- Within 8-30 days, only in the case of normal use, we will provide free maintenance, free replacement. The shipping cost need to be born by the customer.
- Within 31-180 days, we will provide technical support via email, and free maintenance. The cost for replacement and shipping need to be born by the customer.
- If it were beyond 180 days, we only provide technical support via email. The other cost need to be born by the customer.

This warranty doesn't cover following cases, and GAMO2 will provide paid maintenance service.

- Doesn't provide order number when asking for maintenance.
- Second-hand products.
- The failure/damage caused by fire, earthquake, flood, public nuisance, lightning strike, salt injury and the other natural disasters.
- The failure/damage caused by dropping or impacting this product during the shipment, movement.
- The failure/damage caused by wrong connection method, or the operation not in accordance with the guide.
- The failure/damage caused by the operation not in accordance with the notices.
- The failure/damage caused by unauthorized modification.

@gamotwo

sales@gamo2.com